



-  : CARRELAGE = 49,20 m<sup>2</sup>
-  : REVETEMENT PLASTIQUE DUR = 71.50 m<sup>2</sup>
-  : VITRES (2 faces) = 3,50 m<sup>2</sup>

# PORT DE LILLE

## BATIMENT L

### PLAN ENTRETIEN DU REVETEMENT DE SOL



PORTS DE LILLE  
Place Leroux de Fauquemont  
CS 91394  
59014 LILLE CEDEX  
Tel: 03.20.22.73.80

Date: 15/07/2021

Echelle: 1/150

Format: A4

1ère Avenue 3ème ETAGE

ZONE 1

Service Aménagement  
Dessin : Denis Wyzuj

1ère AVENUE

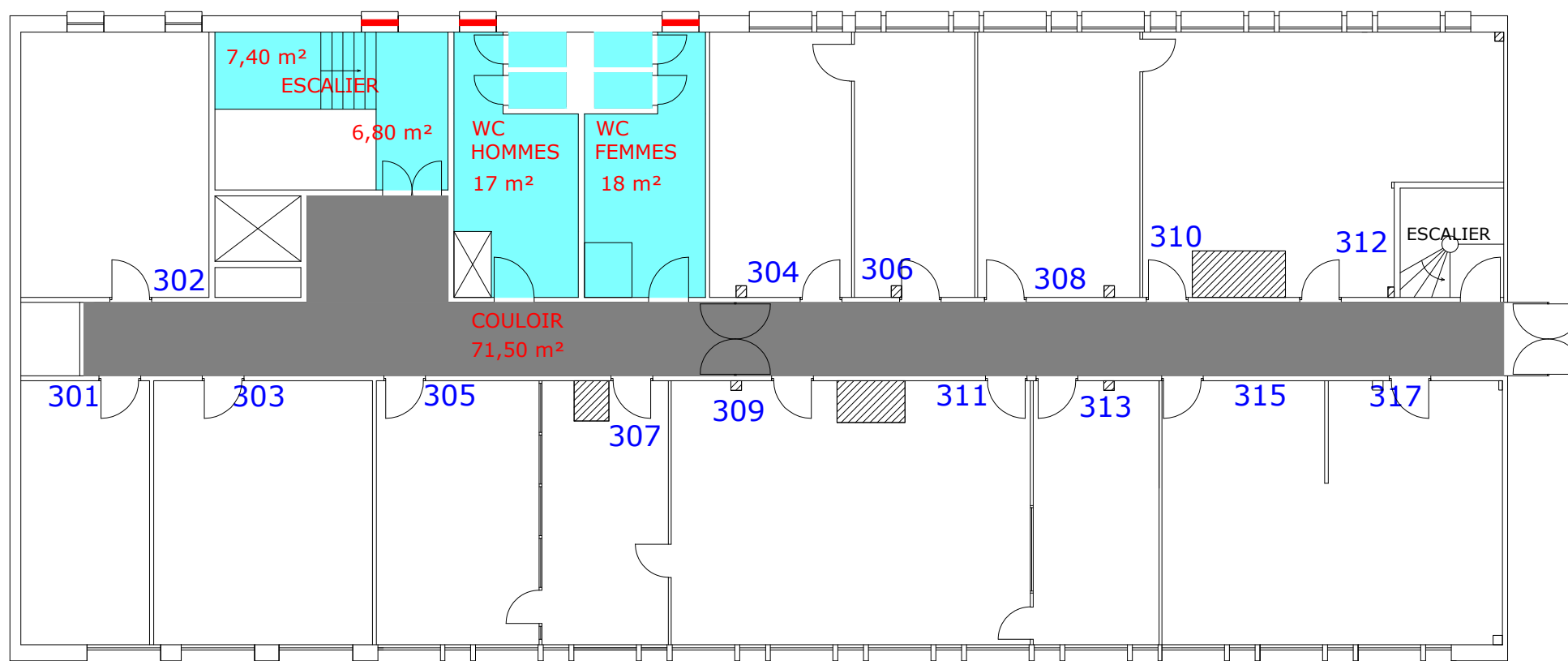

COTE QUAÏ